

LOCATION PLAN  
1 : 1250

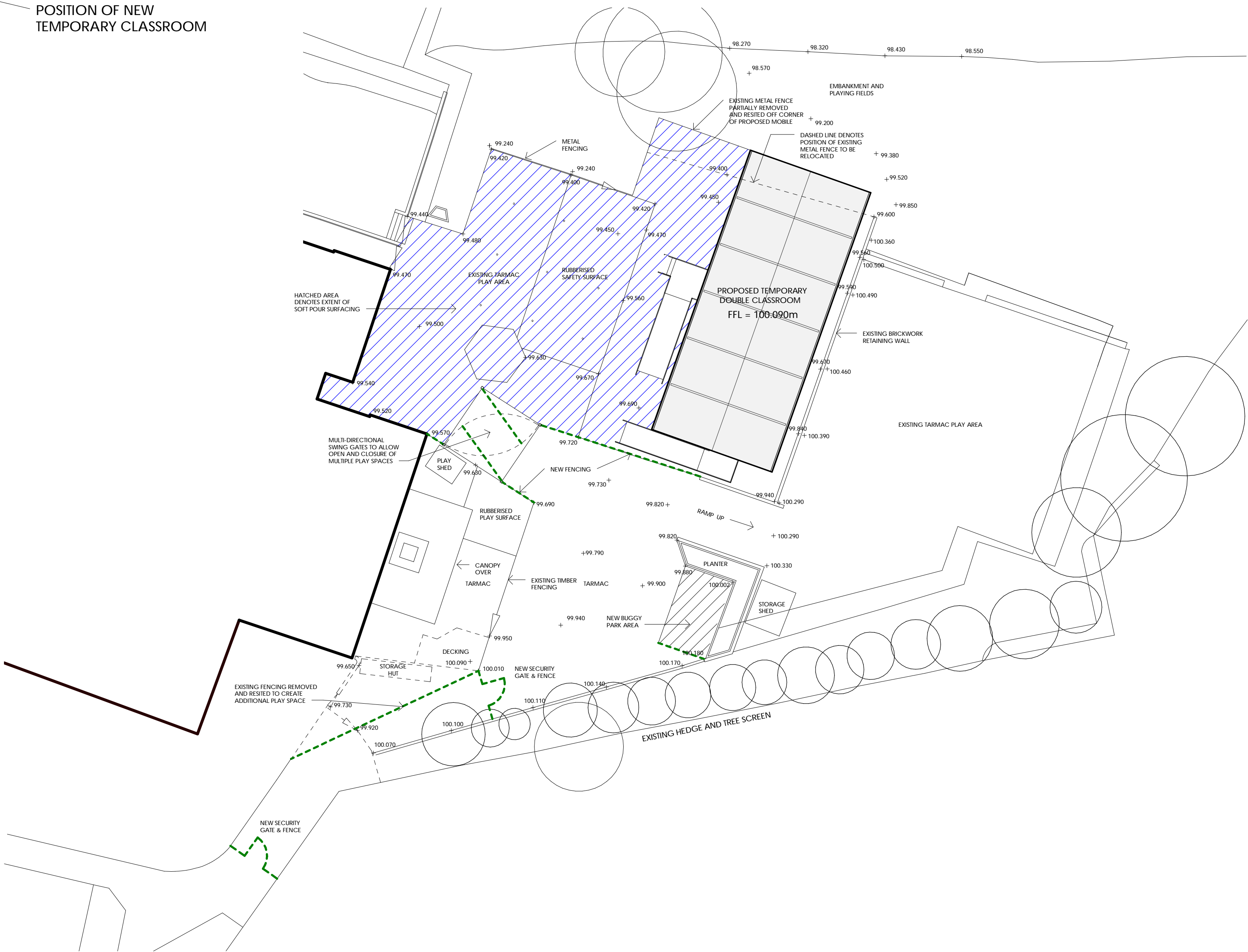

SITE PLAN  
1 : 200

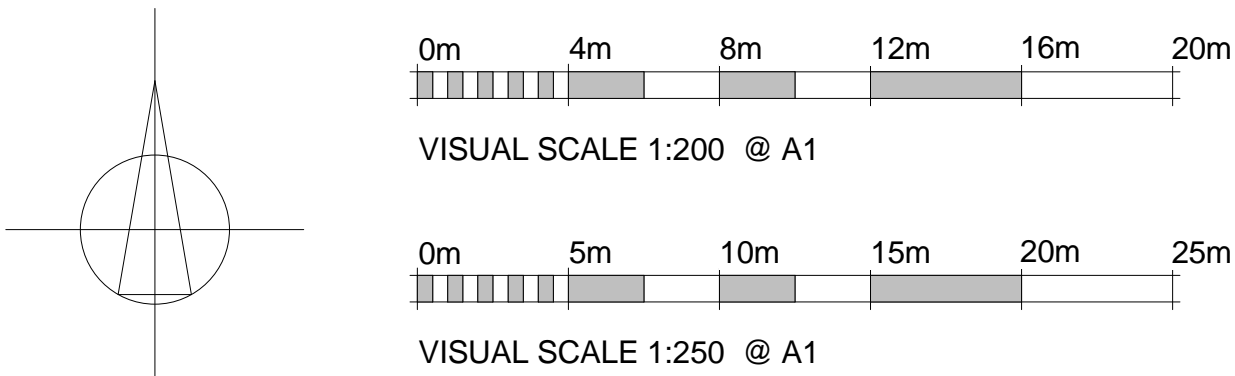

- General Notes
- 1) This drawing is the copyright of the ermc limited and may not be altered or reproduced in any way without the written permission of ermc limited
  - 2) Written dimensions supersede manual or electronically scaled dimensions. All dimensions must be checked on site by Contractor before commencement of the works or fabrication
  - 3) This drawing is to be used only for the purposes intended as described in the Drawing title box.
  - 4) This drawing must be read in conjunction with all other Consultants drawings & specifications applicable to this project.

B	22.05.15	DRAWINGS UPDATED TO SUIT MOBILE SITE AND APPEARANCE CHANGES	RJA	CIC
A	08.04.15	RED LINE EXTENDED FOR PLANNING	RJA	CIC
Rev	Date	Item	By	Chkd
Revisions				

PLANNING ISSUE

**ermc**  
ARCHITECTURE

Newhaven Enterprise Centre  
Denton Island  
Newhaven  
East Sussex  
BN9 9BA  
T: 01323 240365  
F: 01983 527587  
E: admin@ermc.co.uk  
W: www.ermc.co.uk

Architectural Technologists - Quantity Surveyors  
Project Managers - CDM Co-ordinators

Client  
EAST SUSSEX COUNTY COUNCIL

Project Title

PROPOSED DOUBLE TEMPORARY CLASSROOM  
SANDOWN PRIMARY SCHOOL, THE RIDGE  
HASTINGS, EAST SUSSEX, TN34 2AA

SITE & LOCATION PLAN

Scale	Date	Drawn	Chkd
As indicated @ A1	25/03/2015	RJA	CIC
Project No.	Stage	Drawing No.	Rev.
1998	- D -	04	B